



# DAVIS

CONSTRUCTION

BUILDING  
INNOVATION

---

EDITION 2

## FOREWORD.

At Davis Construction, we are fully committed to sustainable growth, and having worked exceptionally hard over the last few years we have now established a solid reputation as one of the most innovative, professional and reliable construction companies in the South of England.

After enjoying a highly successful 2016, with a large number of successful projects, happy clients and earning two highly regarded business awards, we are now looking to build on this and take the company to the next level in the coming years.

The past year has seen the launch of our new brand, website and the first of many annual charity events for 'Oh My Gosh!'. With each project we take on, we continue to expand our knowledge and develop our delivery of superior commercial and residential building solutions.



### TOM DAVIS

As Managing Director of Davis Construction, Tom oversees the successful running and growth of the company, monitoring company procedures and meeting new and existing clients.

---

**WINNER**

IoD East of England Director of the Year Awards 2017

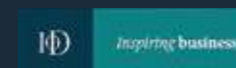



## CONTENTS.

ABOUT US	6
HEALTH & SAFETY	9
THE TEAM	10
YEAR IN REVIEW	13
OH MY GOSH FOUNDATION	18
DAVIS IN THE PRESS	22
SCHOOL SAFETY	24
NEW OFFICE	26
A POSITIVE YEAR FOR GROWTH	28
OUR SERVICES	31
HEALTHCARE	32
EDUCATION	34
RESIDENTIAL	36



# ABOUT US.

At Davis Construction, we specialise in the effective planning, management and delivery of commercial & residential building projects.

Working throughout London and across the South East, our commitment to innovative solutions and efficient project delivery has seen us grow an impressive portfolio of clients across a diverse range of industries.

In particular, our company has developed over the years to become the specialist partner of choice for organisations in the healthcare and education sectors. But no matter the project, we work meticulously from concept through to completion to deliver a comprehensive, forward-thinking service.

# OUR SERVICES.

We deliver a comprehensive range of building solutions for projects in sectors such as:

- ⊕ PUBLIC
- ⊕ HEALTHCARE
- ✎ EDUCATION
- 🏠 RESIDENTIAL

# CORE VALUES.

Davis Construction is committed to upholding our seven core values in every project that we undertake. We keep these values in mind so that we consistently conduct ourselves in a professional, ethical and legal manner. These values are:



# ACCREDITATIONS.

Thanks to our innovative approach, we've received accreditation from these leading industry bodies:



CHAS is established as the market leader for health & safety pre-qualification in the UK. As a CHAS accredited business, Davis Construction has been assessed to meet stringent health and safety standards.



Constructionline is a register for pre-qualified contractors in the UK that have been assessed in all areas of health & safety, including risk assessment, report procedures and training. Davis Construction is proud to be a Constructionline accredited business.



ISO 9001 is a certified Quality Management System (QMS) for businesses who can prove their ability to consistently provide products and services that meet the needs of their customers. ISO 14001 is an internationally recognised standard to help organisations create an effective Environmental Management System (EMS). Davis Construction has earned these accreditations through strong customer focus, quality management and awareness of environmental impact.

# SAFETY BY INSTINCT.

At Davis Construction we have a continued commitment to providing a safe workplace for our clients and staff, and we adopt a zero-tolerance policy on unsafe working practices.

Due to our work in specialist areas including schools and hospitals, we've adopted stringent procedures to ensure minimal risk on site. Our meticulous safety measures are also carried through to our high-quality residential projects. Every project is overseen by our dedicated Health & Safety Manager who produces detailed construction phase plans, risk assessments and method statements, working closely with site managers to ensure all procedures are being followed.

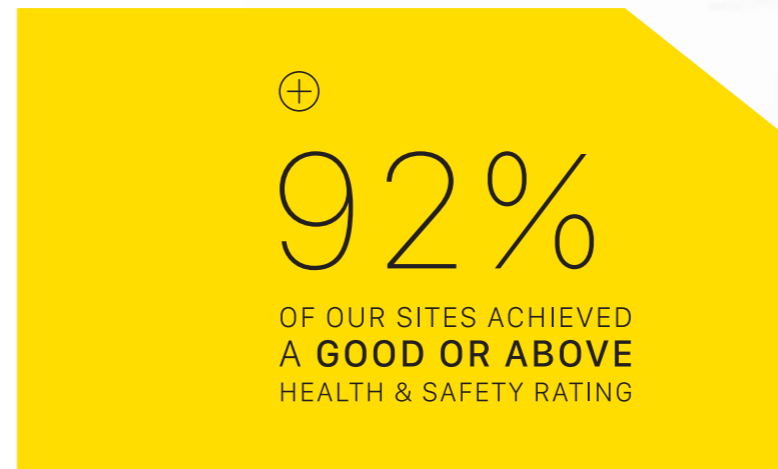

We would like to note that the procedures, management and implementations Davis Construction have in place for this project are exceptional. In terms of CDM and Health & Safety, this site is of a high standard and we look forward to this continuing throughout the project. We would like to emphasise that this is the best site we have visited in some time, and credit should be given to Tom, James and Phil, along with other operatives at Davis.

Daniel Connal Partnership



# THE TEAM.

At Davis Construction, we specialise in the effective planning, management and delivery of commercial and residential building projects.



**TOM DAVIS**  
MANAGING DIRECTOR

As Managing Director of Davis Construction, Tom oversees the successful running and growth of the company, monitoring company procedures and meeting new and existing clients.



**NICOLE PRESTON**  
MANAGING ESTIMATOR

As Managing Estimator, Nicole creates, reviews and delegates estimations throughout the estimation department. She keeps the team on track, sets staff schedules and implements procedures for time and cost efficiency.



**MARK DALBY**  
ESTIMATOR

Working under our Managing Estimator, Nicole Preston, Mark determines the cost of achieving a client's vision. He's with them to the end of the line, making sure the costs reflect the initial predictions.



**LEWIS HAMILTON**  
TRAINEE ESTIMATOR

Working closely with Nicole and Mark, as Trainee Estimator Lewis assists with tenders whilst also learning how to keep estimations on time and within budget.



**BERNARD DAVIS**  
CONTRACTS MANAGER

Bernard expertly and professionally manages projects, monitoring health & safety on site and ensuring works are completed to the highest of standards.



**JAMIE MILNE**  
CONTRACTS MANAGER

Based in our Southend office, Jamie liaises with clients and attends weekly site meetings to ensure our projects are running on time and to budget.



**MATT CORSHAM**  
CONTRACTS MANAGER

As Contract Manager Matt plays a pivotal role in every project, from concept through to completion. He's responsible for the successful managing and delivering of the construction site.



**JON LIVEMORE**  
CONTRACTS MANAGER

Jon keeps an open line of communication between the client, us and any subcontractors. Essential to ensuring projects are completed to the highest standard, on time and on budget.



**NATALIE ANDERSON**  
FINANCE MANAGER

As Finance Manager Natalie is responsible for managing our cashflow and ensuring all invoices are paid on time. At Davis we take great pride in our noncontractual approach to payments.



**NICK SAYER**  
HEALTH & SAFETY MANAGER

Supported by an assistant, Nick is responsible for all elements of Health & Safety. He oversees the construction phase plans and risk assessments, whilst working closely with site managers to ensure safety is maintained on site at all times.



2016

YEAR IN REVIEW



# OUR YEAR IN REVIEW.

At Davis Construction, we are extremely proud of the growth and progression that was achieved in the space of just one year.

At the start of our successful year, the creation of our new brand and website gave us a platform from which we could showcase our forward-thinking and innovative abilities. 2016 saw a number of successful projects, including our work in specialist environments across healthcare and school sectors.

Most notably, our greatest achievement of 2016 was receiving not one but two prestigious business awards. These awards are a reflection of not only our hard work but also our dedication to professionalism and reliability. Successful leadership has also been recognised at Davis Construction with Managing Director Tom winning 'Family Business Director of the Year' at the 2017 Director of the Year Awards, held by the Institute of Directors.

We are also very pleased to announce that our Oh My Gosh! charity raised £30,000 for Great Ormond Street Hospital. With the next charity event and extreme challenge already scheduled, we can only hope that this year will be even bigger and better!

OPEN TO SEE OUR FULL YEAR IN REVIEW





### BRAND NEW BRAND

Our new brand was developed in order to reflect the delivery of our innovative solutions and ability to carry out specialist projects.



### INTERNAL ESTABLISHED ESTIMATION DEPT.

The addition of our Estimation Department allowed us to become more competitive, taking on more bids and tendering for more work.



### BRAND NEW WEBSITE

Our new website showcases our impressive portfolio of clients across a diverse range of industries.



### INTERNAL APPOINTED H&S MANAGER

Nick Sayer was appointed and is responsible for all elements of H&S, including risk assessments and working with site managers.



### AWARDS BEST BUSINESS AWARDS

Awarded the 'Best SME National Business' at the 2016 Best Business Awards.



### WORKS: EXTENSION/REFURB ROSEWOOD MEDICAL CENTRE

Working to our stringent Health & Safety standards, we carried out a full refurbishment and extension of the GP surgery.



### WORKS: REFURB ST. MARY'S SCHOOL REFURB

We undertook a full refurbishment and renovation project on the annexe of the school within a 16-week timeframe.



### WORKS: NEW BUILD BRIDGE ROAD

We were instructed to build brand new homes finished to exceptionally high standards and quality.



### AWARDS ESSEX BUSINESS AWARDS

Awarded the 'Best Growing Business' at the 2016 Essex Business Awards.



### WORKS: NEW BUILD SALVATION ARMY HADLEIGH

Total rebuild of the Hadleigh Community HQ for The Salvation Army. The project was 100% funded by donations from the community.



### WORKS: FLAT CONVERSION SOUTHCHURCH ROAD

This project involved an internal strip-out and conversion of an old commercial building into 16 new flats.



### WORKS: REFURB YATELEY MEDICAL CENTRE

Designed to take pressure off the local A&E, we refurbished an out-of-use dental suite into an out-of-hours minor injury suite.



### CHARITY OH MY GOSH! EVENT

An incredible evening of fine dining and dancing taking the 2016 Oh My Gosh! fundraising total to £30,000.



### CHARITY OH MY GOSH! SKYDIVE

26 brave souls took part in our extreme challenge of skydiving and fundraised nearly £18,000 between them!





Oh  
My  
Gosh!

Oh My Gosh!

A CHARITY EVENT FOR THE CHILDREN OF  
**GREAT ORMOND STREET HOSPITAL**

HOSTED BY TOM DAVIS



# Oh My Gosh!

— 2016 —

With the success of last year's event, we can't wait to come back bigger and better this year to raise even more money for Great Ormond Street Hospital. Check out how we managed to raise £30,000 in 2016.

## TOGETHER WE RAISED £30,000

In October of last year we saw 120 guests come together for an incredible evening of fine dining, dancing and a little too much drinking at the Roslin Hotel for what was the first of many Oh My Gosh! events held in aid of Great Ormond Street Hospital. We also saw 26 brave souls take part in our extreme challenge of skydiving and fundraise nearly £18,000 between them! The event received an overwhelming amount of support, with donations and money raised on the evening reaching £30,000 for poorly children.



# Oh My Gosh!

## 2017



Now in its second year, the annual Oh My Gosh! charity evening is a Great Ormond Street Hospital fundraiser like no other.

Taking place at the Roslin Hotel, this exclusive event brings together local business owners, their employees, friends and family for a truly unforgettable night of dancing, dining and – most importantly – raising money for this wonderful cause.

Following the success of last year, the 2017 Oh My Gosh! charity event is already fully sold out! For the more adventurous guests, this year those that are brave enough will face a hair-raising 194ft abseil down Southend Civic Centre!

Tom Davis

TOM DAVIS

# DAVIS IN THE PRESS.

Our dedication to producing superior projects and our commitment to providing workspaces that are safe for our clients and staff has seen our work hit the news.

As we undertake many projects in schools, we wanted to maximise the safety of the children and felt it was our responsibility to help them understand the dangers of a worksite. Ensuring that they could work in a safe environment, we devised a presentation that explains how they can keep safe whilst we work in their school. Our presentation video was picked up by Construction News allowing multiple readers to see how we engage with children to help them grasp the concept of safety.

One of our most rewarding projects was our total renewal of the Hadleigh Community HQ for The Salvation Army. The project was 100% funded by donations from the community, bringing life back to the building and reinstating it as a centre for public engagement. It was a privilege to be involved in the project from start to finish and to finally complete what the Southend Echo described as a '13-year quest' for a space for community events.



# AWARDS.

We're proud that our hard work and dedication has been recognised through some of the most prestigious business awards. However, although Davis Construction sees these awards as great achievements, we're still determined to build upon this success and drive the company forward by sticking to our core values.



## ESSEX BEST BUSINESS EXCELLENCE AWARDS 2016.

The prestigious Essex Business Excellence Awards take place annually and have been running for nineteen years. Designed to acknowledge the success of private businesses, public sector organisations and charities of all sizes from across the county, we were honoured to be presented with the 'Best Growing Business' award. We were delighted to be recognised for all of our hard work that has led to our successful growth.



## BEST BUSINESS AWARDS 2016.

The Best Business Awards are one of the UK's highest profile awards and winning one speaks volumes for the success of our company. It was an honour to be presented with the 'Best SME National Business' award that is only presented to companies that show innovation and present impressive financials which showcase a fully functional business plan.



## IOD EAST OF ENGLAND DIRECTOR OF THE YEAR 2017.

The annual Director of the Year Awards are held every year across the UK in recognition of successful leadership. Having been shortlisted by the Institute of Directors (IoD) in the Director of the Year Awards 2017, we're pleased to announce that Managing Director, Tom Davis was presented with the prestigious 'Family Business Director of the Year' award.

# SCHOOL SAFETY.

As specialists in construction, we are well-aware of the safety hazards surrounding the completion of building works in schools. That's why when carrying out projects within live school environments, our strict Health & Safety procedures come into full force.

With experience working in a range of specialist areas including schools and hospitals, we've developed stringent Health & Safety procedures that ensure minimal risk in these particular environments. After carrying out rigorous risk assessments we work closely with our site managers and clients to ensure everyone understands the risks and how to stay safe. And if we're working in schools, we even educate the children about the dangers of a worksite and how they can avoid them.



The Davis Construction safety presentation teaches children about the dangers of the worksite and how they can keep safe, helping them to genuinely grasp the concept of safety.



Delivering a project in a school within term time poses a number of risks whilst there are many children around. In order to provide a safe environment with minimal disruption, we've developed an engaging, child-friendly presentation that teaches the children about why we're in their school, what we're doing and most importantly how they can keep safe whilst we're around.



We feel that a very important part of keeping people safe around construction sites is communication. Children are less likely to pay attention to signs and may be curious as to what goes on. It occurred to us that rather than leave this to teachers and parents, we could deliver a tailor-made presentation to children regarding what happens in a construction site and the sorts of things that we do to keep people safe, with the overriding message being that children should never enter construction sites.

**NICK SAYER**  
HEALTH & SAFETY



# NEW OFFICE.

After a significant year of growth and progression, we put plans into place to find an office space in line with our new brand and developing company.

The new office will be a three-storey building featuring a training and meeting room, waiting area, breakout space, as well as a pool table, football table and golf putting green for staff to enjoy in their downtime. The new fitout plans include sleek designs, with the distinctive Davis Construction colours running throughout. We hope to create a space for our clients and staff alike, that reflects our forward-thinking, innovative techniques, unifying our brand across the company.

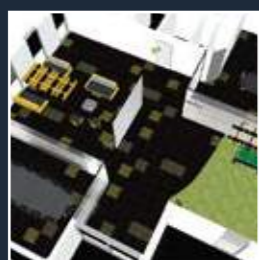

# A POSITIVE YEAR FOR GROWTH.

Following the successes of 2016, we're confident that 2017 will be another productive year with a healthy number of projects already confirmed at the beginning of the year. Building on our award-winning success of last year, we're growing our team so that we can strengthen our service offering, streamline our management and delivery, and increase our contracts.

As the partner of choice for a number of organisations in the education and healthcare sectors, we're looking to continue our delivery of high-quality, specialist projects, and hope to further increase our relationships with other organisations from these sectors.

With our continued dedication to delivering superior projects coupled with our stringent and effective safety measures, we predict that by the end of 2017 we'll be looking towards even further growth in 2018.

⊕  
**£13.5M**  
PREDICTED  
TURNOVER FOR 2017

With each target being met or exceeded, our progression is set to continue with £13.5m predicted turnover for this year.

⊕  
**£15M**  
PREDICTED TOTAL  
AWARDED WORKS

With continual positive growth, heading towards the end of the year our predicted total works is estimated at £15m.

⊕  
**WINNER**  
**IoD East of England**  
**Director of the Year Awards**  
2017

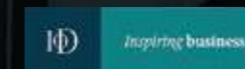

Managing Director, Tom Davis was presented with the prestigious 'Family Business Director of the Year' award.

We're extremely proud that Tom was also shortlisted as a finalist for 'CEO of the Year' at the European Business Awards.

⊕  
**12** NEW DIRECT  
EMPLOYEES

In order to manage our growing project delivery, we're appointing new team members with the necessary expertise to help take Davis Construction to the next level.

⊕  
**£8M**  
**CONFIRMED WORK**  
BY END OF MARCH

Our reputation for delivering high-quality projects with a superior finish across the residential, healthcare and education sectors has seen us secure £8m worth of contracts by the end of March.

⊕  
**JAN 2017**

Our aim for the year ahead is focused on the development of the company and the increased procurement of specialist contracts with organisations in the healthcare and education sectors.



## OUR SERVICES.

Over the years, our development of innovative solutions has led us to become the specialist partner of choice for several organisations in the healthcare and education sectors. Coupled with our vast portfolio of residential projects, our steadfast reputation across all three of our services has been built on the exceptional level of attention to detail and high-quality finish that goes into every project.

With the healthcare and education sectors posing their own individual challenges, we've developed a deep understanding of these environments and how to make sure we cause minimum disruption. From carefully working around state-of-the-art hospital equipment to ensuring students understand how to stay safe around a building site, we've devised solutions for every eventuality.

Our trusted reputation in these sectors is also well-established in our delivery of residential projects. Whether it's our very own high-spec design and build project or we're working as contractors helping developers to bring their projects to life, our work is always completed to the highest standard.



Ingleton Wood have worked on many projects with Davis Construction ranging from healthcare and education to residential and private. They have always provided a high standard of workmanship and client care whilst maintaining a cost effective and timely service. On every project they have been responsive and conscientious, meeting client requirements and impressing with their professional approach.

**Christopher Mabbutt**  
Senior Associate Building Surveyor, Ingleton Wood





SERVICES

# HEALTHCARE.

## ALWAYS ON TIME AND BUDGET.

Our specialist knowledge of the healthcare sector means we're asked time and again by public and private hospitals, surgeries and clinics to deliver top-quality projects. This has helped us establish a reputation as one of the most trusted healthcare construction companies across the South of England.

We work closely with every healthcare facility to develop open lines of communication, dealing with any issues that might arise with a proactive attitude, meaning we consistently deliver each of our projects on time and on budget.



Davis Construction have successfully completed numerous projects for us over the past five years. They have always delivered a high-end product, along with a full service to the client. Works are always finished on time, within our budget and, on many occasions, with the client in occupation. I would not hesitate to recommend them or use them again in the future.

Alan Kelly  
Group Project Manager,  
Aspen Healthcare



## HIGH STANDARDS. LOW RISK.

We understand that healthcare construction projects bring with them their own set of unique challenges, particularly when working within a live hospital. These might include infection control, access issues, working around state-of-the-art hospital equipment and minimising disruption to staff and patients.

Our understanding of these issues means we're well-placed to deliver healthcare projects through our careful and considered approach, paying an unrivalled level of attention to the strategic planning phase of the project.



The Holly Private Hospital, MRI suite.

## CONSTRUCTION COMPLETED WITH SURGICAL PRECISION.

At Davis Construction, we care about the level of care you provide to your patients, which is why we're committed to delivering healthcare construction projects to an exceptional standard – and with minimal disruption.

From large-scale NHS-compliant refurbishments to high-spec private remodels, we are experienced in creating smart, structured environments that are designed to increase comfort and convenience to patients and staff alike.



Highgate Private Hospital, Recovery suite.



## SERVICES EDUCATION.

### CREATING INSPIRING LEARNING ENVIRONMENTS.

Not all school construction companies are the same. Running through to our core is the belief that a teacher can perform their role best when they're given the right tools for the job, and this starts with their working environment.

That's why we're committed to delivering innovative yet practical school builds, renovations and refurbishments that inspire students and staff alike.



We have worked with Davis Construction for many years and have always found that their consistent and attentive support fits very neatly with our approach to providing a first class service. We have served The King John School, among other clients, for over ten years and have delivered a whole range of projects. Davis Construction are amongst the most competent partners we have engaged through this period. Their attitude is both practical and professional, and they provide clear management of the scheme both on and off site. The end results speak for themselves.

Lee Hatwell  
Director, Munday and Cramer



### ON TIME, ON BUDGET & WITH MINIMAL DISRUPTION.

Our specialist knowledge of the education sector along with our history of delivering high-quality projects on time and on budget, has made us one of the go-to construction companies for school construction in the South of England.

We know that schools are often faced with tight budgets and timescales, which is why we work closely with the school throughout each and every stage of the project, keeping them informed and developing open lines of communication so any issues can be dealt with swiftly and proactively.

### HEALTH & SAFETY AT AN A\* STANDARD.

If there's one thing we don't need educating on, it's health & safety. We apply the same unfaltering approach to health & safety during any project but this is of critical importance during a school build.

We are experienced in working within live school environments and are therefore committed to sharing the importance of remaining safe around a building site with students. That's why we give a bespoke health and safety presentation, catered to the project and audience, during every school construction project we undertake. They are designed to communicate to students how to remain safe whilst a build is underway.



Shaw Primary Academy, Admin block.



King John School, Humanities block.



## SERVICES

# RESIDENTIAL.

### HOME ON TIME.

15 years' experience of working on residential projects, small and large, has taught us exactly how to deliver on time and on budget. Meticulous planning and a proactive attitude means that on any project we undertake, the keys are handed over on time, 100% of the time.



The attention to detail – both in terms of the set up and management of the site – is excellent, as is the workmanship of the end product. All of our clients who employed Davis Construction were very happy, especially as the projects were delivered on time and on budget.

BGA Architects



### WORKING AS ONE WITH DEVELOPERS.

Whilst we regularly complete works as a residential construction company in our own right, we also work as contractors for developers to bring your project to life. We develop open lines of communication with both developers and architects to ensure your vision is achieved to its full potential.

In every project we undertake, we apply the same meticulous health and safety policy. Our dedicated health and safety advisor is there to implement this. We also aim to deliver social value, working conscientiously and in a way that enhances the local community.



Flat conversion, Southchurch Road

### BUILT FOR LIVING.

From large residential developments to high-spec design and build projects, the portfolio of residential projects that we can deliver is vast. No matter the size of the project, we're committed to delivering the same exceptional level of care and attention to detail that we would expect in a home of our own.



New build home, Tyrone Road



# GET IN TOUCH.

Have a project in mind? Contact Davis Construction to find out more about how we can make your project a reality.

T. +44 (0)1702 601 000  
F. +44 (0)1702 601 799

E. [info@davisconstruction.co.uk](mailto:info@davisconstruction.co.uk)

[DAVISCONSTRUCTION.co.uk](http://DAVISCONSTRUCTION.co.uk)





277 South Avenue  
Southend-on-Sea  
Essex SS2 4HS

T. +44 (0)1702 601 000  
F. +44 (0)1702 601 799  
E. [info@davisconstruction.co.uk](mailto:info@davisconstruction.co.uk)

[DAVISCONSTRUCTION.co.uk](http://DAVISCONSTRUCTION.co.uk)